

## Hex Rod Coupler Nut

**Thread Type:** Metric - Coarse

**Thread Direction:** Right Hand

**Material:** Carbon Steel

**Class Grade:** Low Tensile Class 5

**Finish:** Zinc Plated

**Corrosion Protection Level:** Moderate

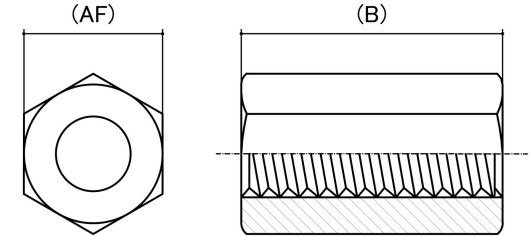

*Cad Drawings shown for graphic representation only.\**

Size	Thread Pitch (mm)	Thread Type	Overall Nut Height (B) (mm)	Across Flats (AF) (mm)		Spanner Size (AF) (mm)	sku (Part Number)
			Nom	Min	Max		
M6	1.00mm	Coarse	18.00	9.78	10.00	10mm	41CO618
M8	1.25mm	Coarse	24.00	12.73	13.00	13mm	41CO824
M10	1.50mm	Coarse	30.00	15.73	16.00	16mm	41CO1030
M12	1.75mm	Coarse	36.00	17.67	18.00	18mm	41CO1236
M16	2.00mm	Coarse	50.00	23.67	24.00	24mm	41CO1650
M20	2.50mm	Coarse	60.00	29.16	30.00	30mm	41CO2060
M24	3.00mm	Coarse	72.00	35.16	36.00	36mm	41CO2472
M30	3.50mm	Coarse	90.00	45.00	46.00	46mm	41CO3090
M36	4.00mm	Coarse	108.00	53.80	55.00	55mm	41CO36108

**Disclaimer:**

Dimensional data and technical information was obtained from publically available sources and not acquired through standard agencies. It has been completed and compiled for reference purposes only; where discrepancies are found they are subject to change without notice. Bolt & Nut Australia makes no warranties or representations regarding the accuracy and validity of the compiled information and data. Contact the relevant standard authorities for accurate and detailed information.

\* Cad Drawings may not reflect diameter, thread length or overall length.

© Bolt & Nut Australia Pty Ltd. All rights reserved.

Version: 25 Aug 2024